

Crosby® Swivel Hooks



SEE APPLICATION AND WARNING INFORMATION

Para Español: www.thecrosbygroup.com On Pages 122 - 123

S-3322 SWIVEL HOOKS WITH BEARING



Suitable for frequent rotation under load.

New anti-friction bearing design allows hook to rotate freely under load.

- Capacities ranging from 2 through 15 metric tonnes.
- Forged - Quenched and Tempered.
- Proper design, careful forging, and precision controlled quench and tempering gives maximum strength without excessive weight and bulk.
- Low profile hook tip designed to utilize Crosby S-4320 or PL-N latch kit. Simply purchase the latch assemblies listed and shown on pages 101 - 103. Even years after purchase of the original hook, latch assemblies can be added.
- S-3322 hooks incorporate markings forged into the product which address two (2) **QUIC-CHECK®** features:
 - **Deformation Indicators** — one just below the shank or eye and the other on the hook tip, which allows for a **QUIC-CHECK®** measurement to determine if the throat opening has changed, thus indicating abuse or overload.
 - **Angle Indicators** — Indicates the maximum included angle which is allowed between two (2) sling legs in the hook. These indicators also provide the opportunity to approximate other included angles between two sling legs.

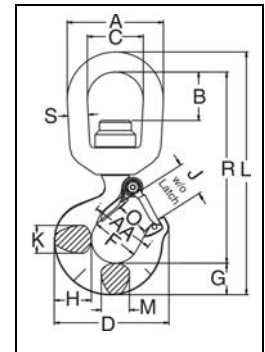

Hook & Swivels

For other swivel hooks designed to rotate under load, see pages 99, 107, 108, 116-119. Use in corrosive environment requires shank and nut inspection in accordance with ASME B30.10-1.2.1(b)(2)(c) 2000.

- U.S. Patents 5,381,650 & 5,193,480 & 5,103,755 and foreign equivalents.

Working Load Limit (t)*	S-3322 Stock No.	L-3322 Stock No.†	Weight Each (kg)	Dimensions (mm)																Rep. Latch Stock No.
				A	B	C	D	F	G	H	J	K	L	M	O	R	S	AA		
2	1028605	1028609	1.13	76.2	38.1	44.5	91.2	38.1	25.4	29.5	26.9	22.4	194	22.4	25.4	152	16.0	50.8	1096421	
3	1028614	1028618	1.72	88.9	39.6	50.8	101	41.1	28.7	33.3	30.2	23.9	218	23.9	27.7	170	19.1	50.8	1096468	
5	1028623	1028627	3.17	101	39.6	57.2	122	50.8	36.6	41.4	38.1	33.3	262	28.7	34.5	203	22.4	63.5	1096515	
7	1028632	1028636	6.35	127	49.3	69.9	159	63.5	46.0	52.3	45.2	42.2	326	36.6	40.9	251	28.7	76.2	1096562	
11	1028641	1028645	10.1	142	52.1	79.2	191	76.2	57.2	66.8	61.2	47.8	387	41.4	52.8	298	31.8	101	1096609	
15	1028650	1028654	17.1	180	91.9	104	211	82.6	65.8	74.7	66.5	55.6	473	49.3	57.7	366	38.1	101	1096657	

* NOTE: Proofload is 2.5 times working load limit. Designed with a 4.5 to 1 design factor.
 † Supplied with latch attached.